

Project Management Initials: Designer: DC
Latest Revision Initials: Checked: CEC
Project Reference Number: 60589004

Last saved by: HATONCM(2022-11-07) Last Plotted: 2022-11-07
Filename: \\NA.AECOM\NET\COM\FILES\ENEA\STALBANS-UNST\1\LEGACY\06\PROJECTS\SUNNICA ENERGY FARMES APPLICATION\CAD\TROS2.WIP\TRAFFIC REGULATION MEASURES_SHEETS_TM.DWG

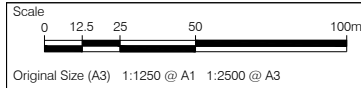

Original Size (A3) 1:1250 @ A1 1:2500 @ A3

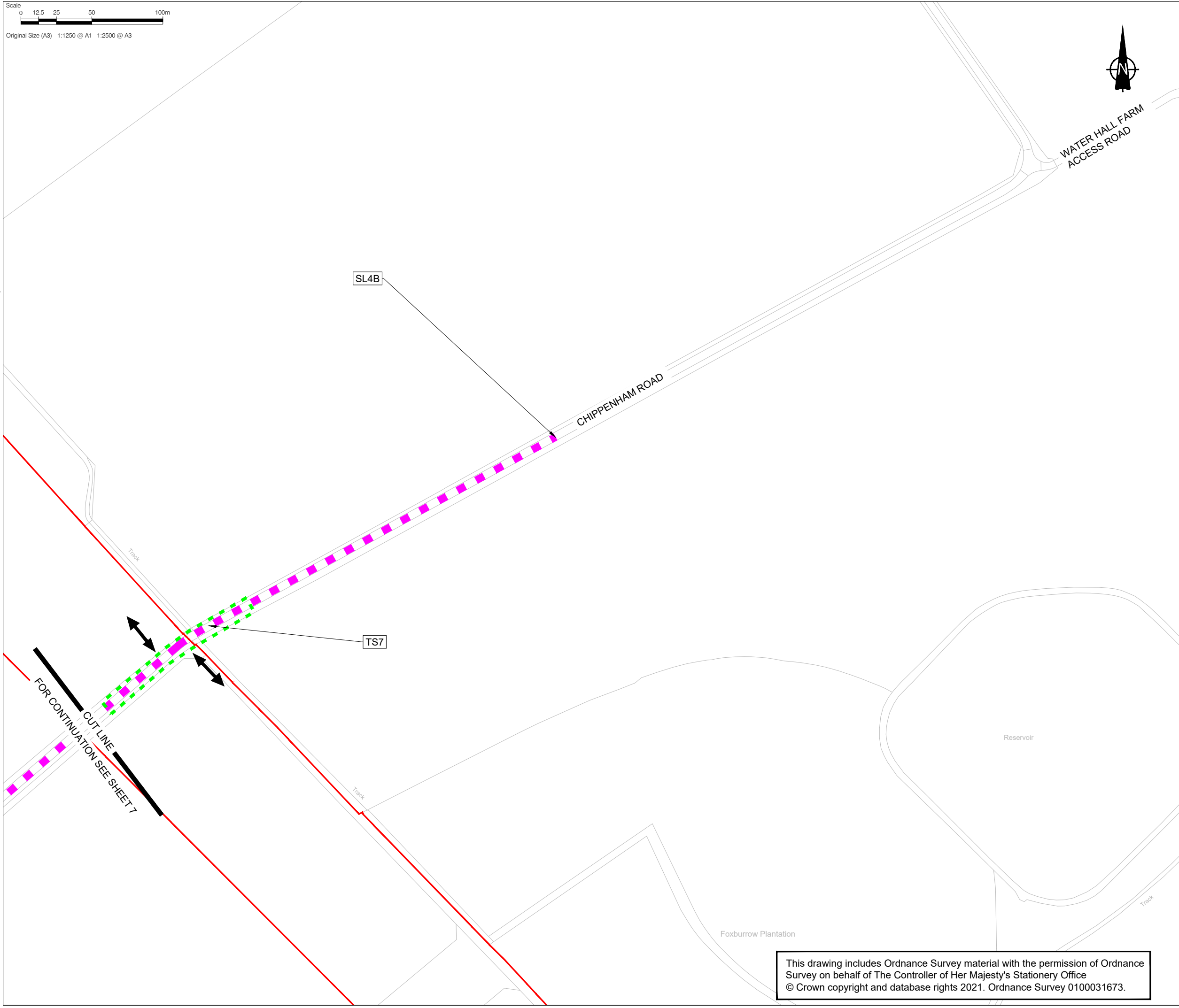

WATER HALL FARM
ACCESS ROAD

CHIPPENHAM ROAD

SL4B

TS7

Reservoir

Foxburrow Plantation

This drawing includes Ordnance Survey material with the permission of Ordnance Survey on behalf of The Controller of Her Majesty's Stationery Office
© Crown copyright and database rights 2021. Ordnance Survey 0100031673.

This drawing has been prepared for the use of AECOM's client. It may not be used, modified, reproduced or relied upon by third parties, except as agreed by AECOM or as required by law. AECOM accepts no responsibility, and denies any liability whatsoever, to any party that uses or relies on this drawing without AECOM's express written consent. Do not scale this document.

AECOM

CONSULTANT

AECOM House, 63-77 Victoria Street,
St. Albans, Hertfordshire, AL1 3ER
+44(0)1727 535000 tel
+44(0)1727 535099 fax
www.aecom.com

PROJECT

Sunnica Energy Farm

CLIENT



NOTE

1. THE TRAFFIC REGULATION MEASURES PLANS SHOULD BE READ IN CONJUNCTION WITH THE DEVELOPMENT CONSENT ORDER AND THE OTHER PLANS AND DOCUMENTS TO BE CERTIFIED BY IT, IN PARTICULAR ARTICLES 11 AND 44 OF, AND SCHEDULES 6 AND 14 TO, THE DEVELOPMENT CONSENT ORDER.
2. THE INDICATIVE ACCESS LOCATIONS SHOWN ON THESE PLANS INDICATE THE GENERAL LOCATION OF THE ACCESSES TO WHICH THE TEMPORARY TRAFFIC SIGNAL MEASURES AND TEMPORARY PROHIBITION MEASURE DESCRIBED IN PARTS 2 AND 4 OF SCHEDULE 14 TO THE DEVELOPMENT CONSENT ORDER, RELATE. THESE PLANS DO NOT SHOW ALL PROPOSED ACCESSES TO THE AUTHORISED DEVELOPMENT. FURTHER INFORMATION ON THE PROPOSED ACCESSES TO THE AUTHORISED DEVELOPMENT CAN BE FOUND IN THE ACCESS AND RIGHTS OF WAY PLANS AND SCHEDULE 7 TO THE DRAFT DCO.
3. THE REQUIREMENT FOR TS1 HAS BEEN REMOVED AND TRAFFIC SIGNALS START AT TS2.

KEY

- ORDER LIMITS
- PROPOSED TEMPORARY SPEED LIMIT (30MPH SPEED LIMIT)
- PROPOSED TEMPORARY SPEED LIMIT (40MPH SPEED LIMIT)
- PROPOSED TEMPORARY TRAFFIC SIGNAL CONTROL AREA
- PROPOSED TEMPORARY PROHIBITION ORDER
- ↔ INDICATIVE SITE ACCESS LOCATION

SHEET PLAN

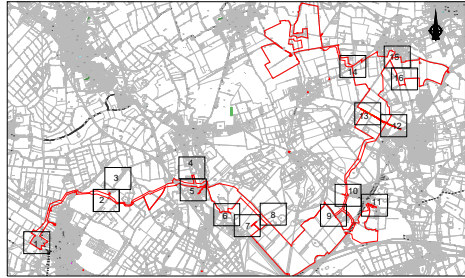

Document Reference: EN010106/APP/2.4

ISSUE/REVISION

I/R	DATE	DESCRIPTION
2	11/11/2022	SUBMITTED AT DEADLINE 2
1	30/08/2022	CHANGE APPLICATION JULY 2022
0	18/11/2021	FOR DCO SUBMISSION

SHEET TITLE

TRAFFIC REGULATION MEASURES PLANS -
TEMPORARY MEASURES
INFRASTRUCTURE PLANNING
(APPLICATIONS: PRESCRIBED FORMS AND
PROCEDURE) REGULATIONS 2009 5(2)(O)
SHEET 8 OF 16

SHEET NUMBER

60589004-TRM-TM-008

SCALE

1:2500 @ A3

Project Management Initials: Designer: DC
Latest Revision Initials: Checked: CEC
Project Reference Number: 60589004
Checked: CEC
Approved: CC
ISO A3 420mm x 297mm

Last saved by: HATTONCM(2022-11-07) Last Plotted: 2022-11-07
Filename: \\NA.AECOM\NET\COM\FSE\ENEA\STALBANS-UNST\1\LEGACY\09\PROJECT\TS\UNNICA ENERGY FARMES APPLICATION\CA\DTROS2.WP1\TRAFFIC REGULATION MEASURES_S\HEETS_TM.DWG

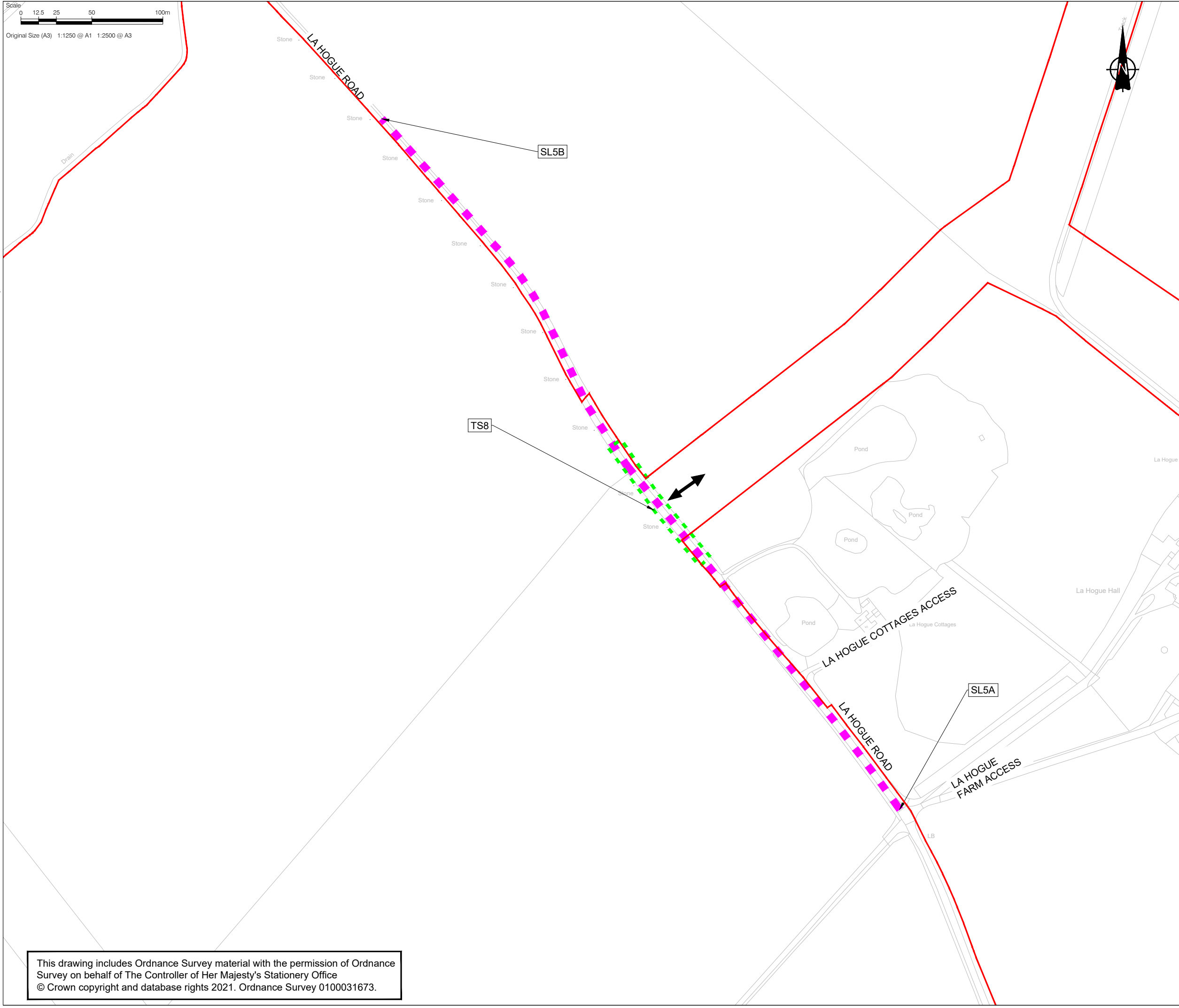

This drawing includes Ordnance Survey material with the permission of Ordnance Survey on behalf of The Controller of Her Majesty's Stationery Office
© Crown copyright and database rights 2021. Ordnance Survey 0100031673.

AECOM

CONSULTANT

AECOM House, 63-77 Victoria Street,
St. Albans, Hertfordshire, AL1 3ER
+44(0)1727 535000 tel
+44(0)1727 535099 fax
www.aecom.com

PROJECT

Sunnica Energy Farm

CLIENT



NOTE

1. THE TRAFFIC REGULATION MEASURES PLANS SHOULD BE READ IN CONJUNCTION WITH THE DEVELOPMENT CONSENT ORDER AND THE OTHER PLANS AND DOCUMENTS TO BE CERTIFIED BY IT, IN PARTICULAR ARTICLES 11 AND 44 OF, AND SCHEDULES 6 AND 14 TO, THE DEVELOPMENT CONSENT ORDER.
2. THE INDICATIVE ACCESS LOCATIONS SHOWN ON THESE PLANS INDICATE THE GENERAL LOCATION OF THE ACCESSES TO WHICH THE TEMPORARY TRAFFIC SIGNAL MEASURES AND TEMPORARY PROHIBITION MEASURE DESCRIBED IN PARTS 2 AND 4 OF SCHEDULE 14 TO THE DEVELOPMENT CONSENT ORDER, RELATE. THESE PLANS DO NOT SHOW ALL PROPOSED ACCESSES TO THE AUTHORISED DEVELOPMENT. FURTHER INFORMATION ON THE PROPOSED ACCESSES TO THE AUTHORISED DEVELOPMENT CAN BE FOUND IN THE ACCESS AND RIGHTS OF WAY PLANS AND SCHEDULE 7 TO THE DRAFT DCO.
3. THE REQUIREMENT FOR TS1 HAS BEEN REMOVED AND TRAFFIC SIGNALS START AT TS2.

KEY

- ORDER LIMITS
- PROPOSED TEMPORARY SPEED LIMIT (30MPH SPEED LIMIT)
- PROPOSED TEMPORARY SPEED LIMIT (40MPH SPEED LIMIT)
- PROPOSED TEMPORARY TRAFFIC SIGNAL CONTROL AREA
- PROPOSED TEMPORARY PROHIBITION ORDER
- ↔ INDICATIVE SITE ACCESS LOCATION

SHEET PLAN

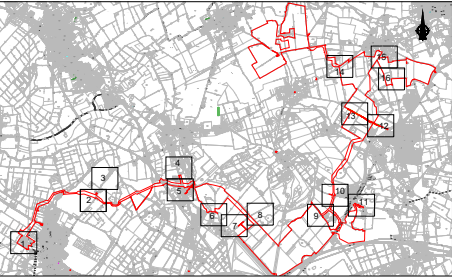

Document Reference: EN010106/APP/2.4

ISSUE/REVISION

2	11/11/2022	SUBMITTED AT DEADLINE 2
1	30/08/2022	CHANGE APPLICATION JULY 2022
0	18/11/2021	FOR DCO SUBMISSION
I/R	DATE	DESCRIPTION

SHEET TITLE

TRAFFIC REGULATION MEASURES PLANS -
TEMPORARY MEASURES
INFRASTRUCTURE PLANNING
(APPLICATIONS: PRESCRIBED FORMS AND
PROCEDURE) REGULATIONS 2009 5(2)(O)
SHEET 9 OF 16

SHEET NUMBER

60589004-TRM-TM-009

SCALE

1:2500 @ A3

This drawing has been prepared for the use of AECOM's client. It may not be used, modified, reproduced or relied upon by third parties, except as agreed by AECOM or as required by law. AECOM accepts no responsibility, and denies any liability whatsoever, to any party that uses or relies on this drawing without AECOM's express written consent. Do not scale this document.

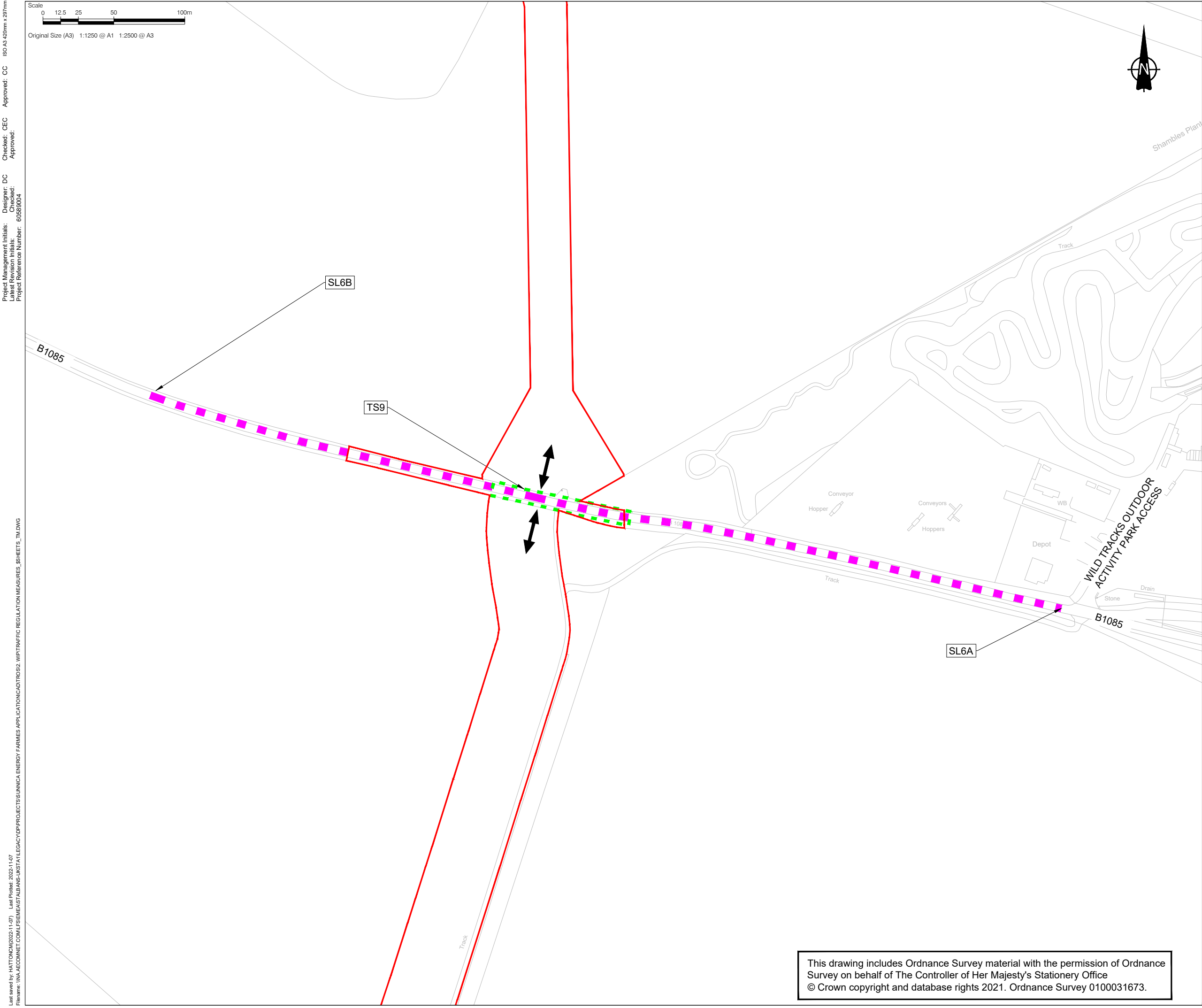

This drawing has been prepared for the use of AECOM's client. It may not be used, modified, reproduced or relied upon by third parties, except as agreed by AECOM or as required by law. AECOM accepts no responsibility, and denies any liability whatsoever, to any party that uses or relies on this drawing without AECOM's express written consent. Do not scale this document.



CONSULTANT

AECOM House, 63-77 Victoria Street,
St. Albans, Hertfordshire, AL1 3ER
+44(0)1727 535000 tel
+44(0)1727 535099 fax
www.aecom.com

PROJECT

Sunnica Energy Farm

CLIENT



NOTE

1. THE TRAFFIC REGULATION MEASURES PLANS SHOULD BE READ IN CONJUNCTION WITH THE DEVELOPMENT CONSENT ORDER AND THE OTHER PLANS AND DOCUMENTS TO BE CERTIFIED BY IT, IN PARTICULAR ARTICLES 11 AND 44 OF, AND SCHEDULES 6 AND 14 TO, THE DEVELOPMENT CONSENT ORDER.
2. THE INDICATIVE ACCESS LOCATIONS SHOWN ON THESE PLANS INDICATE THE GENERAL LOCATION OF THE ACCESSES TO WHICH THE TEMPORARY TRAFFIC SIGNAL MEASURES AND TEMPORARY PROHIBITION MEASURE DESCRIBED IN PARTS 2 AND 4 OF SCHEDULE 14 TO THE DEVELOPMENT CONSENT ORDER, RELATE. THESE PLANS DO NOT SHOW ALL PROPOSED ACCESSES TO THE AUTHORISED DEVELOPMENT. FURTHER INFORMATION ON THE PROPOSED ACCESSES TO THE AUTHORISED DEVELOPMENT CAN BE FOUND IN THE ACCESS AND RIGHTS OF WAY PLANS AND SCHEDULE 7 TO THE DRAFT DCO.
3. THE REQUIREMENT FOR TS1 HAS BEEN REMOVED AND TRAFFIC SIGNALS START AT TS2.

KEY

- ORDER LIMITS
- PROPOSED TEMPORARY SPEED LIMIT (30MPH SPEED LIMIT)
- PROPOSED TEMPORARY SPEED LIMIT (40MPH SPEED LIMIT)
- PROPOSED TEMPORARY TRAFFIC SIGNAL CONTROL AREA
- PROPOSED TEMPORARY PROHIBITION ORDER
- INDICATIVE SITE ACCESS LOCATION

SHEET PLAN

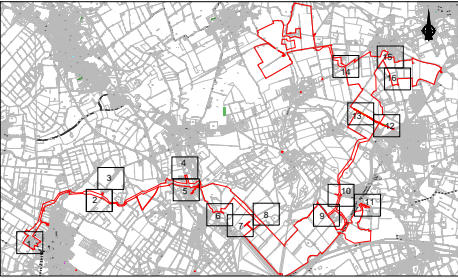

Document Reference: EN010106/APP/2.4

ISSUE/REVISION

2	11/11/2022	SUBMITTED AT DEADLINE 2
1	30/08/2022	CHANGE APPLICATION JULY 2022
0	18/11/2021	FOR DCO SUBMISSION
I/R	DATE	DESCRIPTION

SHEET TITLE

TRAFFIC REGULATION MEASURES PLANS -
TEMPORARY MEASURES
INFRASTRUCTURE PLANNING
(APPLICATIONS: PRESCRIBED FORMS AND
PROCEDURE) REGULATIONS 2009 5(2)(O)
SHEET 10 OF 16

SHEET NUMBER

60589004-TRM-TM-010

SCALE

1:2500 @ A3

This drawing includes Ordnance Survey material with the permission of Ordnance Survey on behalf of The Controller of Her Majesty's Stationery Office
© Crown copyright and database rights 2021. Ordnance Survey 0100031673.

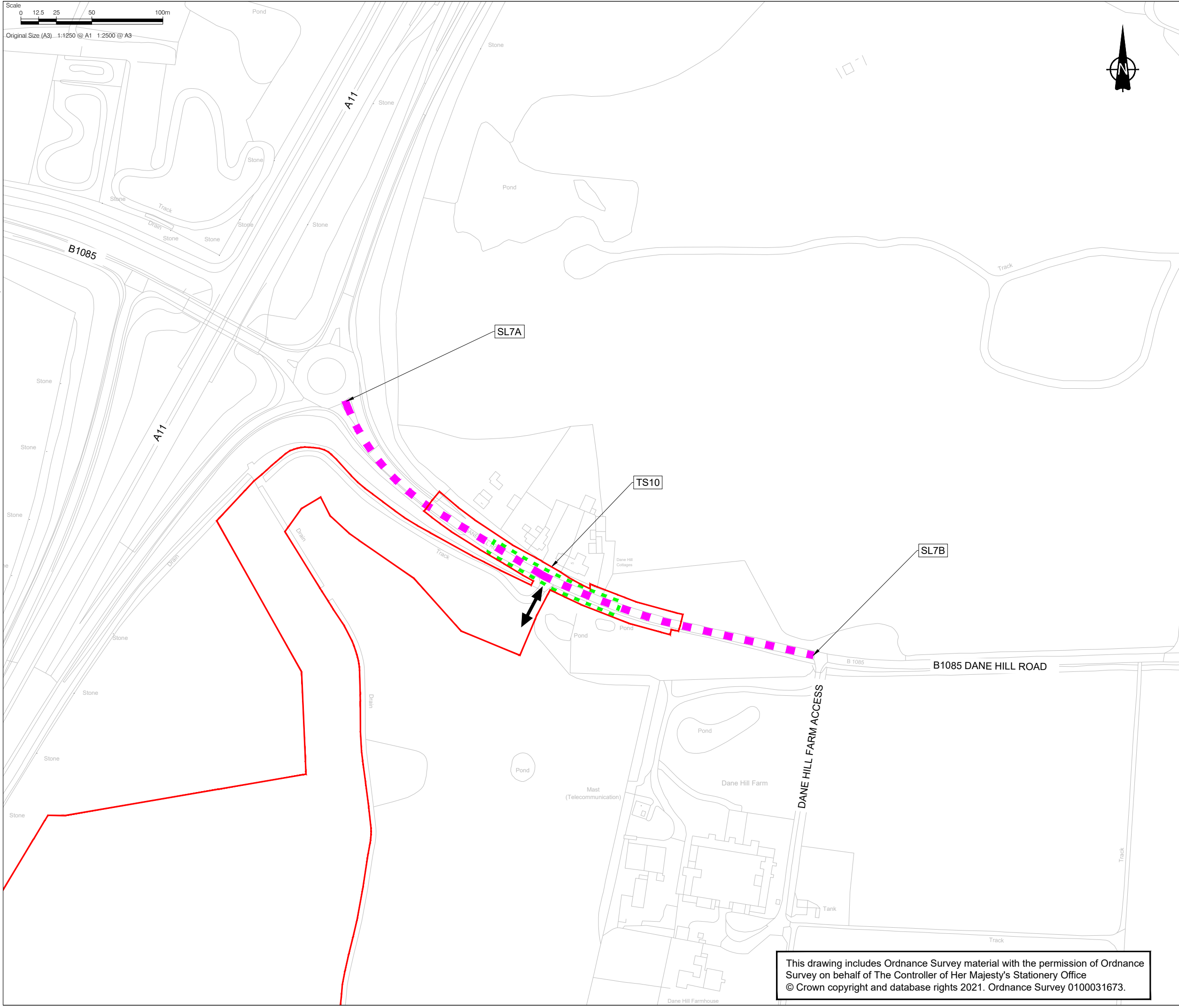

This drawing has been prepared for the use of AECOM's client. It may not be used, modified, reproduced or relied upon by third parties, except as agreed by AECOM or as required by law. AECOM accepts no responsibility, and denies any liability whatsoever, to any party that uses or relies on this drawing without AECOM's express written consent. Do not scale this document.



CONSULTANT

AECOM House, 63-77 Victoria Street,
St. Albans, Hertfordshire, AL1 3ER
+44(0)1727 535000 tel
+44(0)1727 535099 fax
www.aecom.com

PROJECT

Sunnica Energy Farm

CLIENT



NOTE

1. THE TRAFFIC REGULATION MEASURES PLANS SHOULD BE READ IN CONJUNCTION WITH THE DEVELOPMENT CONSENT ORDER AND THE OTHER PLANS AND DOCUMENTS TO BE CERTIFIED BY IT, IN PARTICULAR ARTICLES 11 AND 44 OF, AND SCHEDULES 6 AND 14 TO, THE DEVELOPMENT CONSENT ORDER.
2. THE INDICATIVE ACCESS LOCATIONS SHOWN ON THESE PLANS INDICATE THE GENERAL LOCATION OF THE ACCESSES TO WHICH THE TEMPORARY TRAFFIC SIGNAL MEASURES AND TEMPORARY PROHIBITION MEASURE DESCRIBED IN PARTS 2 AND 4 OF SCHEDULE 14 TO THE DEVELOPMENT CONSENT ORDER, RELATE. THESE PLANS DO NOT SHOW ALL PROPOSED ACCESSES TO THE AUTHORISED DEVELOPMENT. FURTHER INFORMATION ON THE PROPOSED ACCESSES TO THE AUTHORISED DEVELOPMENT CAN BE FOUND IN THE ACCESS AND RIGHTS OF WAY PLANS AND SCHEDULE 7 TO THE DRAFT DCO.
3. THE REQUIREMENT FOR TS1 HAS BEEN REMOVED AND TRAFFIC SIGNALS START AT TS2.

KEY

- ORDER LIMITS
- PROPOSED TEMPORARY SPEED LIMIT (30MPH SPEED LIMIT)
- PROPOSED TEMPORARY SPEED LIMIT (40MPH SPEED LIMIT)
- PROPOSED TEMPORARY TRAFFIC SIGNAL CONTROL AREA
- PROPOSED TEMPORARY PROHIBITION ORDER
- ↔ INDICATIVE SITE ACCESS LOCATION

SHEET PLAN

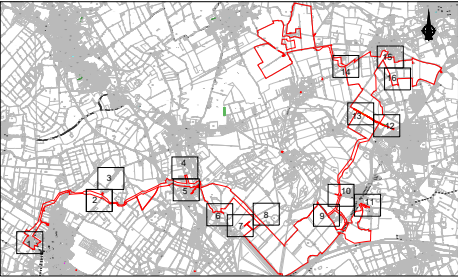

Document Reference: EN010106/APP/2.4
ISSUE/REVISION

I/R	DATE	DESCRIPTION
2	11/11/2022	SUBMITTED AT DEADLINE 2
1	30/08/2022	CHANGE APPLICATION JULY 2022
0	18/11/2021	FOR DCO SUBMISSION

SHEET TITLE

TRAFFIC REGULATION MEASURES PLANS -
TEMPORARY MEASURES
INFRASTRUCTURE PLANNING
(APPLICATIONS: PRESCRIBED FORMS AND
PROCEDURE) REGULATIONS 2009 5(2)(O)
SHEET 11 OF 16

SHEET NUMBER

60589004-TRM-TM-011

SCALE

1:2500 @ A3

This drawing includes Ordnance Survey material with the permission of Ordnance Survey on behalf of The Controller of Her Majesty's Stationery Office
© Crown copyright and database rights 2021. Ordnance Survey 0100031673.

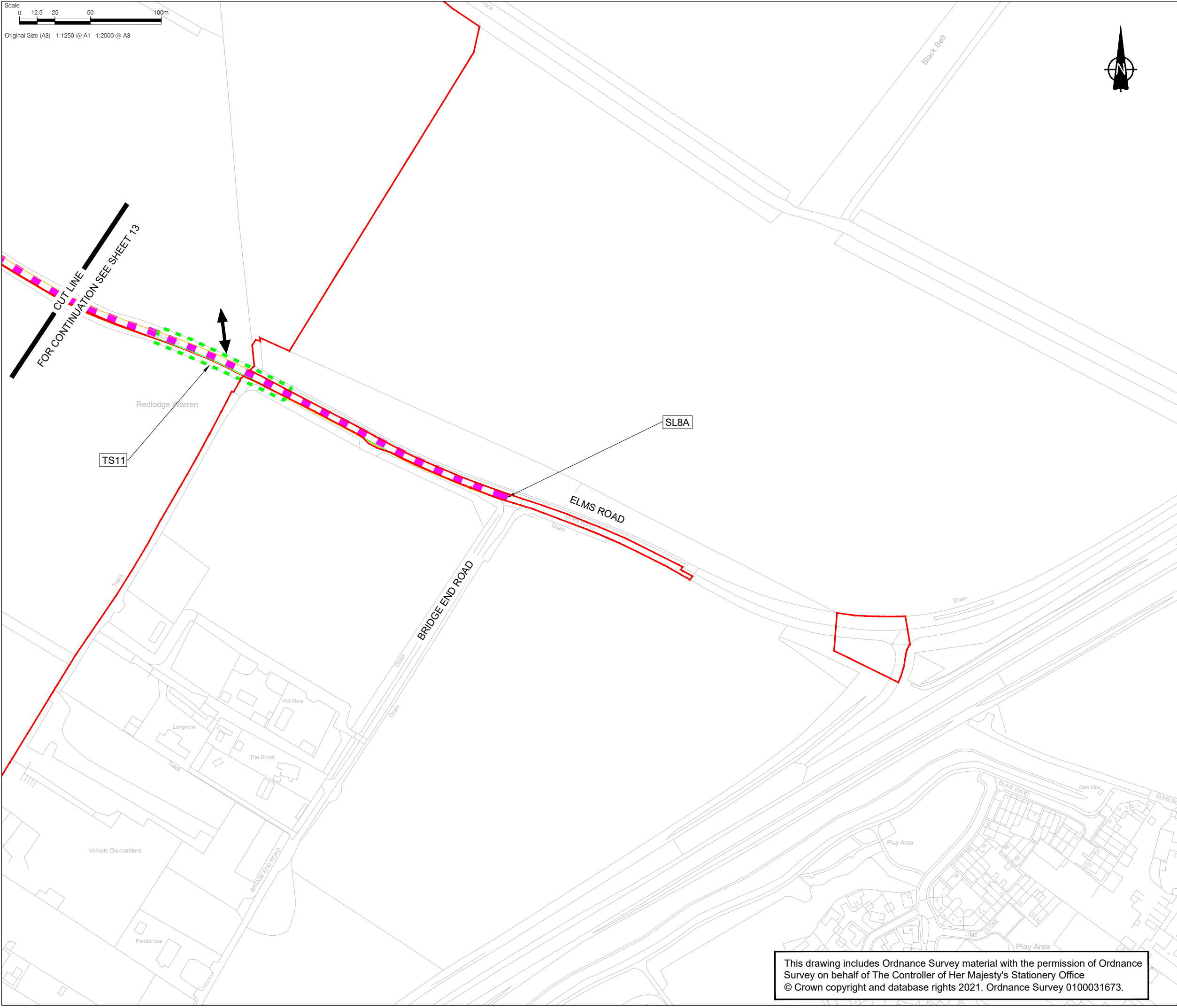

This drawing has been prepared for the use of AECOM's client. It may not be used, modified, reproduced or relied upon by third parties, except as agreed by AECOM or as required by law. AECOM accepts no responsibility, and denies any liability whatsoever, to any party that uses or relies on this drawing without AECOM's express written consent. Do not scale this document.



CONSULTANT

AECOM House, 63-77 Victoria Street,
St. Albans, Hertfordshire, AL1 3ER
+44(0)1727 535000 tel
+44(0)1727 535099 fax
www.aecom.com

PROJECT

Sunnica Energy Farm

CLIENT



NOTE

1. THE TRAFFIC REGULATION MEASURES PLANS SHOULD BE READ IN CONJUNCTION WITH THE DEVELOPMENT CONSENT ORDER AND THE OTHER PLANS AND DOCUMENTS TO BE CERTIFIED BY IT, IN PARTICULAR ARTICLES 11 AND 44 OF, AND SCHEDULES 6 AND 14 TO, THE DEVELOPMENT CONSENT ORDER.
2. THE INDICATIVE ACCESS LOCATIONS SHOWN ON THESE PLANS INDICATE THE GENERAL LOCATION OF THE ACCESSES TO WHICH THE TEMPORARY TRAFFIC SIGNAL MEASURES AND TEMPORARY PROHIBITION MEASURE DESCRIBED IN PARTS 2 AND 4 OF SCHEDULE 14 TO THE DEVELOPMENT CONSENT ORDER, RELATE. THESE PLANS DO NOT SHOW ALL PROPOSED ACCESSES TO THE AUTHORISED DEVELOPMENT. FURTHER INFORMATION ON THE PROPOSED ACCESSES TO THE AUTHORISED DEVELOPMENT CAN BE FOUND IN THE ACCESS AND RIGHTS OF WAY PLANS AND SCHEDULE 7 TO THE DRAFT DCO.
3. THE REQUIREMENT FOR TS1 HAS BEEN REMOVED AND TRAFFIC SIGNALS START AT TS2.

KEY

- ORDER LIMITS
- PROPOSED TEMPORARY SPEED LIMIT (30MPH SPEED LIMIT)
- PROPOSED TEMPORARY SPEED LIMIT (40MPH SPEED LIMIT)
- PROPOSED TEMPORARY TRAFFIC SIGNAL CONTROL AREA
- PROPOSED TEMPORARY PROHIBITION ORDER
- INDICATIVE SITE ACCESS LOCATION

SHEET PLAN

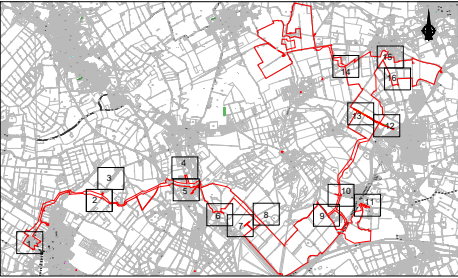

Document Reference: EN010106/APP/2.4

ISSUE/REVISION

2	11/11/2022	SUBMITTED AT DEADLINE 2
1	30/08/2022	CHANGE APPLICATION JULY 2022
0	18/11/2021	FOR DCO SUBMISSION
I/R	DATE	DESCRIPTION

SHEET TITLE

TRAFFIC REGULATION MEASURES PLANS -
TEMPORARY MEASURES
INFRASTRUCTURE PLANNING
(APPLICATIONS: PRESCRIBED FORMS AND
PROCEDURE) REGULATIONS 2009 5(2)(O)
SHEET 12 OF 16

SHEET NUMBER

60589004-TRM-TM-012

SCALE

1:2500 @ A3

This drawing includes Ordnance Survey material with the permission of Ordnance Survey on behalf of The Controller of Her Majesty's Stationery Office
© Crown copyright and database rights 2021. Ordnance Survey 0100031673.

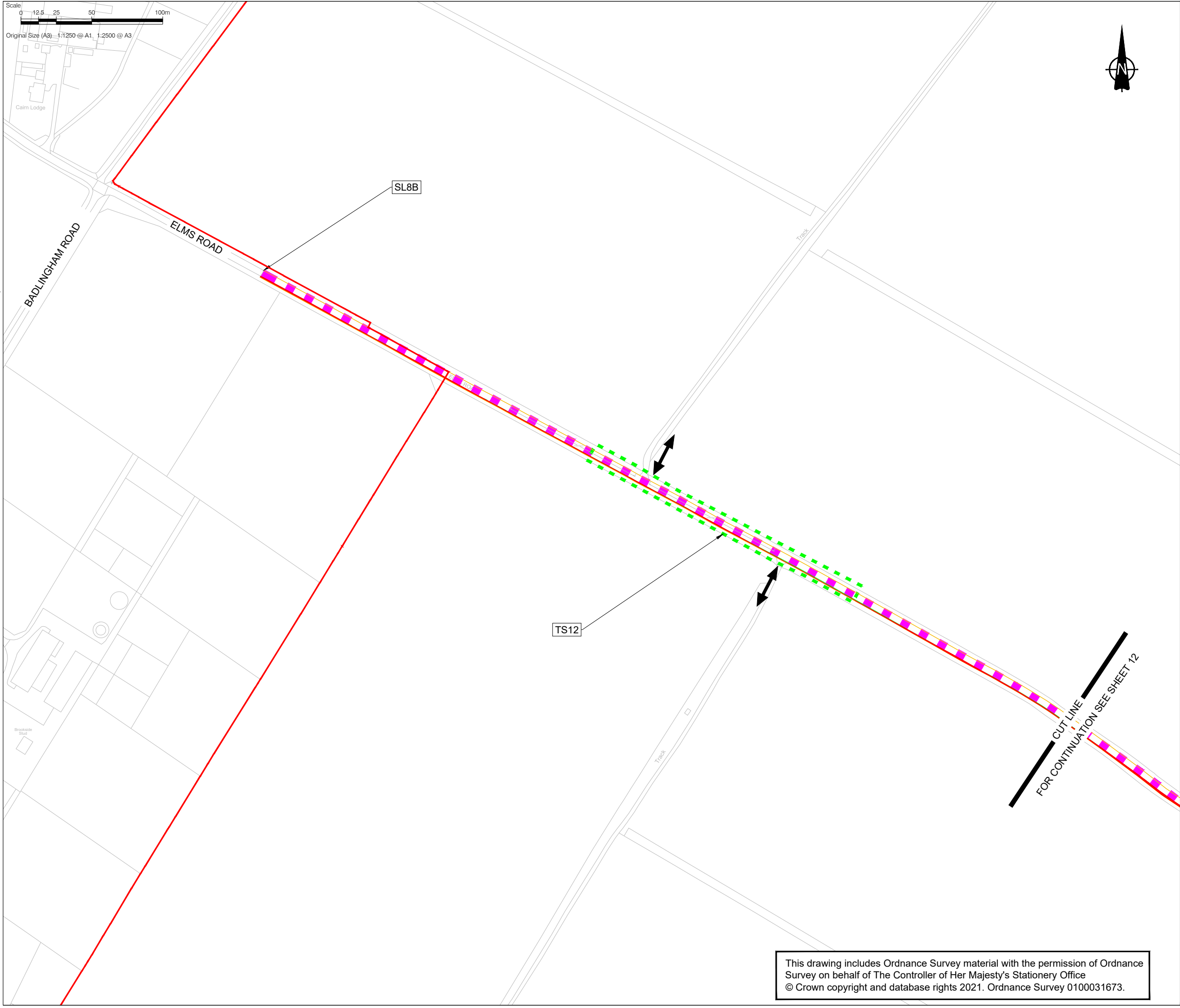

This drawing has been prepared for the use of AECOM's client. It may not be used, modified, reproduced or relied upon by third parties, except as agreed by AECOM or as required by law. AECOM accepts no responsibility, and denies any liability whatsoever, to any party that uses or relies on this drawing without AECOM's express written consent. Do not scale this document.



CONSULTANT

AECOM House, 63-77 Victoria Street,
St. Albans, Hertfordshire, AL1 3ER
+44(0)1727 535000 tel
+44(0)1727 535099 fax
www.aecom.com

PROJECT

Sunnica Energy Farm

CLIENT



NOTE

1. THE TRAFFIC REGULATION MEASURES PLANS SHOULD BE READ IN CONJUNCTION WITH THE DEVELOPMENT CONSENT ORDER AND THE OTHER PLANS AND DOCUMENTS TO BE CERTIFIED BY IT, IN PARTICULAR ARTICLES 11 AND 44 OF, AND SCHEDULES 6 AND 14 TO, THE DEVELOPMENT CONSENT ORDER.
2. THE INDICATIVE ACCESS LOCATIONS SHOWN ON THESE PLANS INDICATE THE GENERAL LOCATION OF THE ACCESSES TO WHICH THE TEMPORARY TRAFFIC SIGNAL MEASURES AND TEMPORARY PROHIBITION MEASURE DESCRIBED IN PARTS 2 AND 4 OF SCHEDULE 14 TO THE DEVELOPMENT CONSENT ORDER, RELATE. THESE PLANS DO NOT SHOW ALL PROPOSED ACCESSES TO THE AUTHORISED DEVELOPMENT. FURTHER INFORMATION ON THE PROPOSED ACCESSES TO THE AUTHORISED DEVELOPMENT CAN BE FOUND IN THE ACCESS AND RIGHTS OF WAY PLANS AND SCHEDULE 7 TO THE DRAFT DCO.
3. THE REQUIREMENT FOR TS1 HAS BEEN REMOVED AND TRAFFIC SIGNALS START AT TS2.

KEY

- ORDER LIMITS
- PROPOSED TEMPORARY SPEED LIMIT (30MPH SPEED LIMIT)
- PROPOSED TEMPORARY SPEED LIMIT (40MPH SPEED LIMIT)
- PROPOSED TEMPORARY TRAFFIC SIGNAL CONTROL AREA
- PROPOSED TEMPORARY PROHIBITION ORDER
- ↔ INDICATIVE SITE ACCESS LOCATION

SHEET PLAN

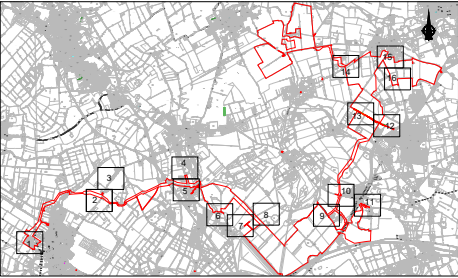

Document Reference: EN010106/APP/2.4

ISSUE/REVISION

2	11/11/2022	SUBMITTED AT DEADLINE 2
1	30/08/2022	CHANGE APPLICATION JULY 2022
0	18/11/2021	FOR DCO SUBMISSION
I/R	DATE	DESCRIPTION

SHEET TITLE

TRAFFIC REGULATION MEASURES PLANS -
TEMPORARY MEASURES
INFRASTRUCTURE PLANNING
(APPLICATIONS: PRESCRIBED FORMS AND
PROCEDURE) REGULATIONS 2009 5(2)(O)
SHEET 13 OF 16

SHEET NUMBER

60589004-TRM-TM-013

SCALE

1:2500 @ A3

This drawing includes Ordnance Survey material with the permission of Ordnance Survey on behalf of The Controller of Her Majesty's Stationery Office
© Crown copyright and database rights 2021. Ordnance Survey 0100031673.

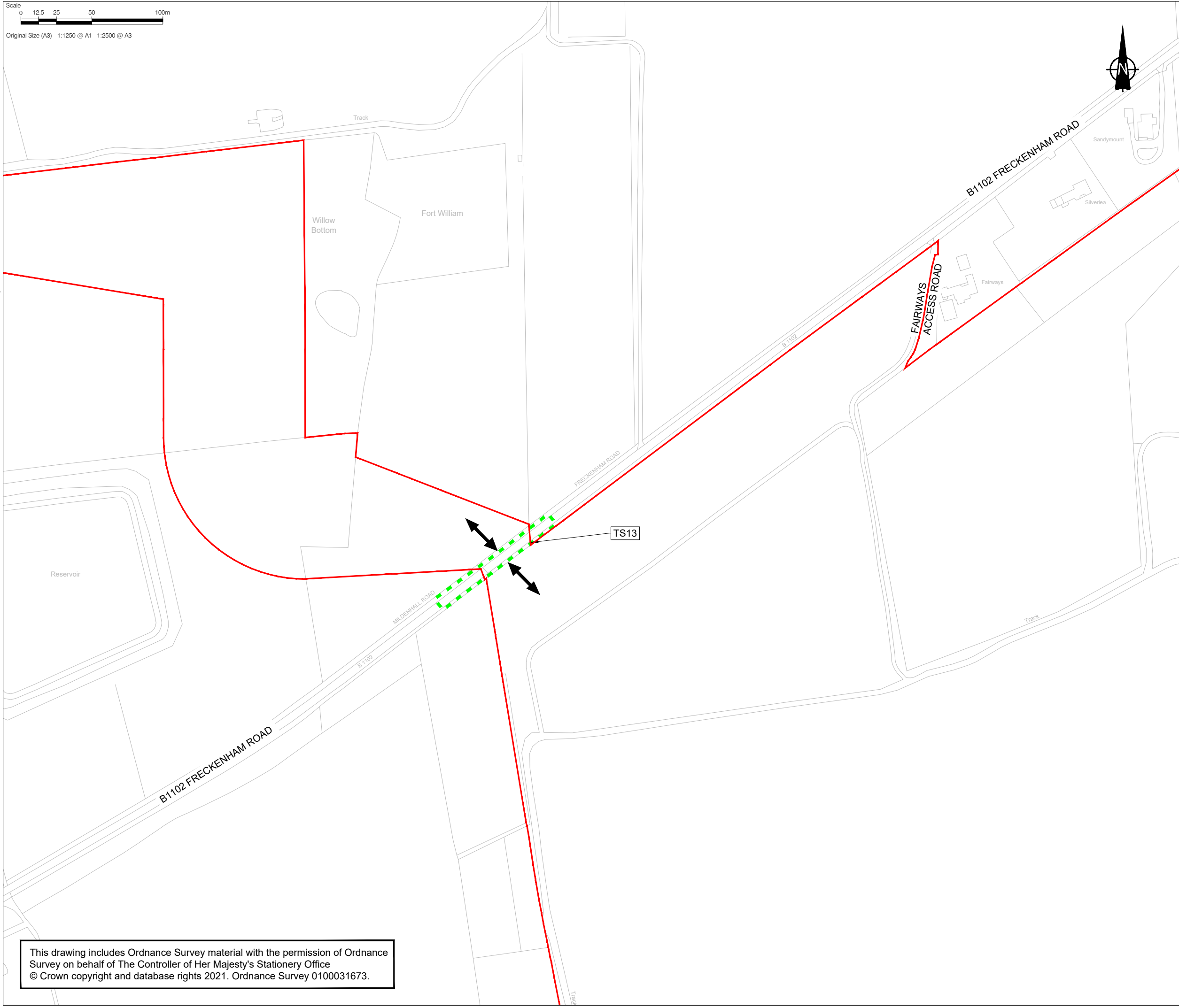

This drawing includes Ordnance Survey material with the permission of Ordnance Survey on behalf of The Controller of Her Majesty's Stationery Office
© Crown copyright and database rights 2021. Ordnance Survey 0100031673.

AECOM

CONSULTANT

AECOM House, 63-77 Victoria Street,
St. Albans, Hertfordshire, AL1 3ER
+44(0)1727 535000 tel
+44(0)1727 535099 fax
www.aecom.com

PROJECT

Sunnica Energy Farm

CLIENT



NOTE

1. THE TRAFFIC REGULATION MEASURES PLANS SHOULD BE READ IN CONJUNCTION WITH THE DEVELOPMENT CONSENT ORDER AND THE OTHER PLANS AND DOCUMENTS TO BE CERTIFIED BY IT, IN PARTICULAR ARTICLES 11 AND 44 OF, AND SCHEDULES 6 AND 14 TO, THE DEVELOPMENT CONSENT ORDER.
2. THE INDICATIVE ACCESS LOCATIONS SHOWN ON THESE PLANS INDICATE THE GENERAL LOCATION OF THE ACCESSES TO WHICH THE TEMPORARY TRAFFIC SIGNAL MEASURES AND TEMPORARY PROHIBITION MEASURE DESCRIBED IN PARTS 2 AND 4 OF SCHEDULE 14 TO THE DEVELOPMENT CONSENT ORDER, RELATE. THESE PLANS DO NOT SHOW ALL PROPOSED ACCESSES TO THE AUTHORISED DEVELOPMENT. FURTHER INFORMATION ON THE PROPOSED ACCESSES TO THE AUTHORISED DEVELOPMENT CAN BE FOUND IN THE ACCESS AND RIGHTS OF WAY PLANS AND SCHEDULE 7 TO THE DRAFT DCO.
3. THE REQUIREMENT FOR TS1 HAS BEEN REMOVED AND TRAFFIC SIGNALS START AT TS2.

KEY

- ORDER LIMITS
- ■ ■ ■ PROPOSED TEMPORARY SPEED LIMIT (30MPH SPEED LIMIT)
- ■ ■ ■ PROPOSED TEMPORARY SPEED LIMIT (40MPH SPEED LIMIT)
- ■ ■ ■ PROPOSED TEMPORARY TRAFFIC SIGNAL CONTROL AREA
- ■ ■ ■ PROPOSED TEMPORARY PROHIBITION ORDER
- ↔ INDICATIVE SITE ACCESS LOCATION

SHEET PLAN

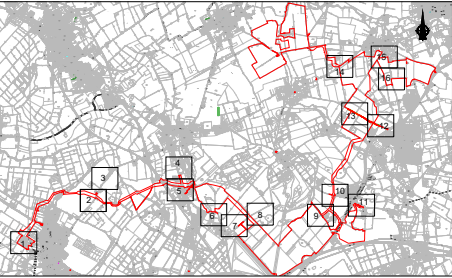

Document Reference: EN010106/APP/2.4

ISSUE/REVISION

I/R	DATE	DESCRIPTION
2	11/11/2022	SUBMITTED AT DEADLINE 2
1	30/08/2022	CHANGE APPLICATION JULY 2022
0	18/11/2021	FOR DCO SUBMISSION

SHEET TITLE

TRAFFIC REGULATION MEASURES PLANS -
TEMPORARY MEASURES
INFRASTRUCTURE PLANNING
(APPLICATIONS: PRESCRIBED FORMS AND
PROCEDURE) REGULATIONS 2009 5(2)(O)
SHEET 14 OF 16

SHEET NUMBER

60589004-TRM-TM-014

SCALE

1:2500 @ A3

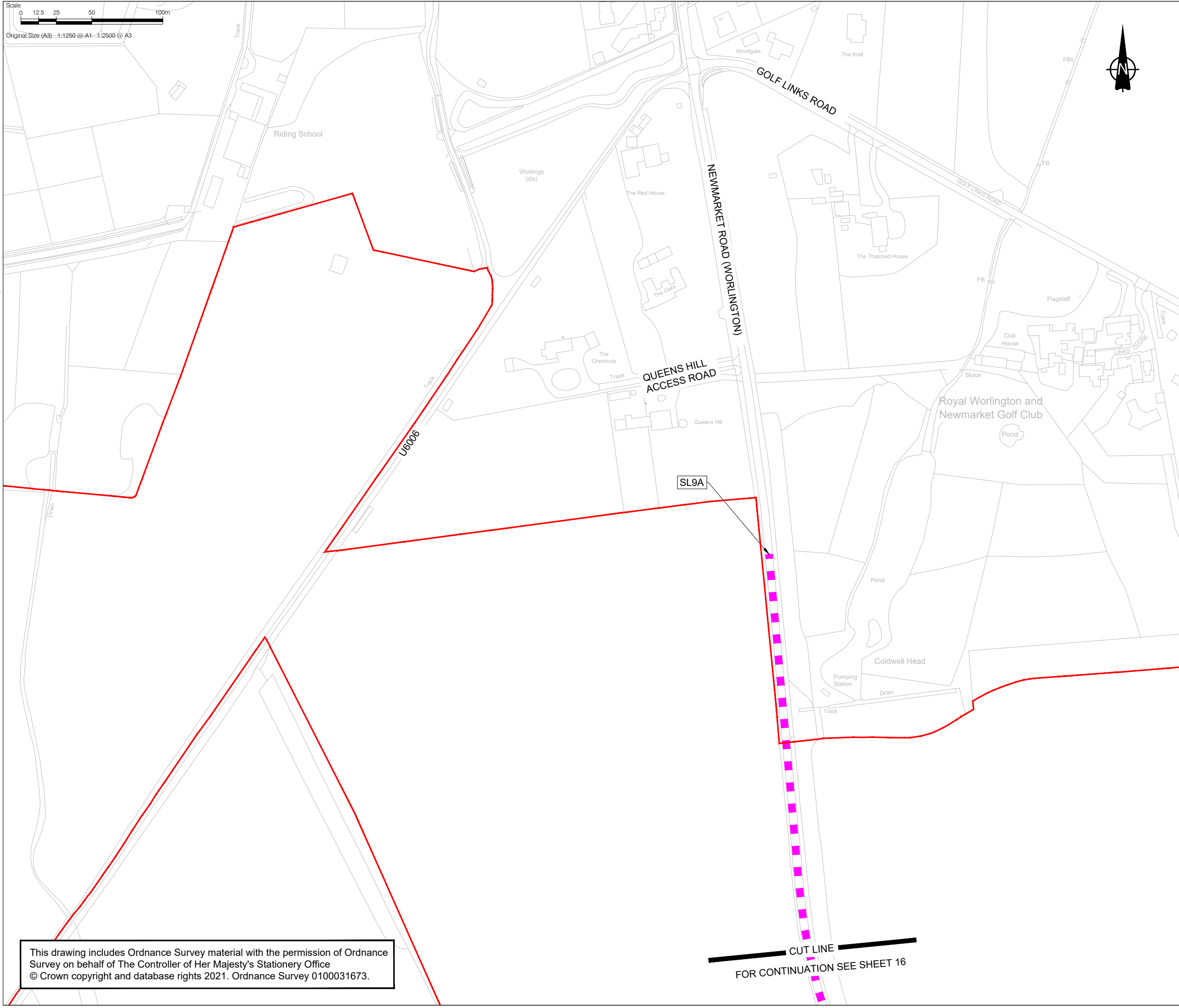

This drawing includes Ordnance Survey material with the permission of Ordnance Survey on behalf of The Controller of Her Majesty's Stationery Office
© Crown copyright and database rights 2021. Ordnance Survey 0100031673.

This drawing has been prepared for the use of AECOM's client. It may not be used, modified, reproduced or relied upon by third parties, except as agreed by AECOM or as required by law. AECOM accepts no responsibility, and denies any liability whatsoever, to any party that uses or relies on this drawing without AECOM's express written consent. Do not scale this document.



CONSULTANT

AECOM House, 63-77 Victoria Street,
St. Albans, Hertfordshire, AL1 3ER
+44(0)1727 535000 tel
+44(0)1727 535099 fax
www.aecom.com

PROJECT

Sunnica Energy Farm

CLIENT



NOTE

1. THE TRAFFIC REGULATION MEASURES PLANS SHOULD BE READ IN CONJUNCTION WITH THE DEVELOPMENT CONSENT ORDER AND THE OTHER PLANS AND DOCUMENTS TO BE CERTIFIED BY IT, IN PARTICULAR ARTICLES 11 AND 44 OF, AND SCHEDULES 6 AND 14 TO, THE DEVELOPMENT CONSENT ORDER.
2. THE INDICATIVE ACCESS LOCATIONS SHOWN ON THESE PLANS INDICATE THE GENERAL LOCATION OF THE ACCESSES TO WHICH THE TEMPORARY TRAFFIC SIGNAL MEASURES AND TEMPORARY PROHIBITION MEASURE DESCRIBED IN PARTS 2 AND 4 OF SCHEDULE 14 TO THE DEVELOPMENT CONSENT ORDER, RELATE. THESE PLANS DO NOT SHOW ALL PROPOSED ACCESSES TO THE AUTHORISED DEVELOPMENT. FURTHER INFORMATION ON THE PROPOSED ACCESSES TO THE AUTHORISED DEVELOPMENT CAN BE FOUND IN THE ACCESS AND RIGHTS OF WAY PLANS AND SCHEDULE 7 TO THE DRAFT DCO.
3. THE REQUIREMENT FOR TS1 HAS BEEN REMOVED AND TRAFFIC SIGNALS START AT TS2.

KEY

- ORDER LIMITS
- PROPOSED TEMPORARY SPEED LIMIT (30MPH SPEED LIMIT)
- PROPOSED TEMPORARY SPEED LIMIT (40MPH SPEED LIMIT)
- PROPOSED TEMPORARY TRAFFIC SIGNAL CONTROL AREA
- PROPOSED TEMPORARY PROHIBITION ORDER
- INDICATIVE SITE ACCESS LOCATION

SHEET PLAN

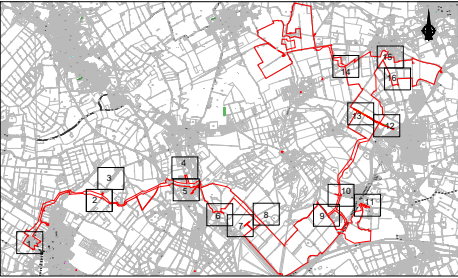

Document Reference: EN010106/APP/2.4

ISSUE/REVISION

2	11/11/2022	SUBMITTED AT DEADLINE 2
1	30/08/2022	CHANGE APPLICATION JULY 2022
0	18/11/2021	FOR DCO SUBMISSION
I/R	DATE	DESCRIPTION

SHEET TITLE

TRAFFIC REGULATION MEASURES PLANS -
TEMPORARY MEASURES
INFRASTRUCTURE PLANNING
(APPLICATIONS: PRESCRIBED FORMS AND
PROCEDURE) REGULATIONS 2009 5(2)(O)
SHEET 15 OF 16

SHEET NUMBER

60589004-TRM-TM-015

SCALE

1:2500 @ A3

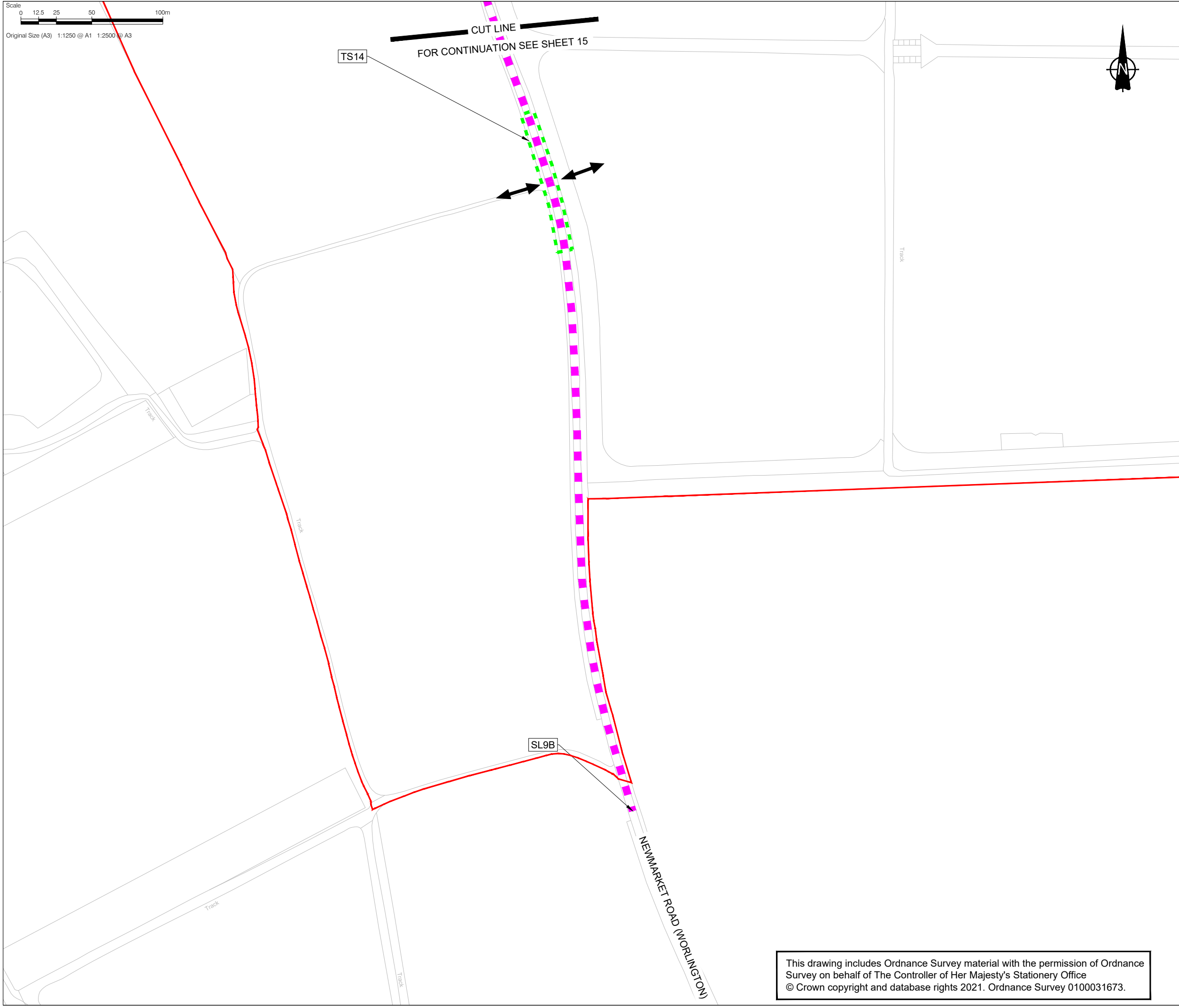

This drawing includes Ordnance Survey material with the permission of Ordnance Survey on behalf of The Controller of Her Majesty's Stationery Office
© Crown copyright and database rights 2021. Ordnance Survey 0100031673.



CONSULTANT

AECOM House, 63-77 Victoria Street,
St. Albans, Hertfordshire, AL1 3ER
+44(0)1727 535000 tel
+44(0)1727 535099 fax
www.aecom.com

PROJECT

Sunnica Energy Farm

CLIENT



NOTE

1. THE TRAFFIC REGULATION MEASURES PLANS SHOULD BE READ IN CONJUNCTION WITH THE DEVELOPMENT CONSENT ORDER AND THE OTHER PLANS AND DOCUMENTS TO BE CERTIFIED BY IT, IN PARTICULAR ARTICLES 11 AND 44 OF, AND SCHEDULES 6 AND 14 TO, THE DEVELOPMENT CONSENT ORDER.
2. THE INDICATIVE ACCESS LOCATIONS SHOWN ON THESE PLANS INDICATE THE GENERAL LOCATION OF THE ACCESSES TO WHICH THE TEMPORARY TRAFFIC SIGNAL MEASURES AND TEMPORARY PROHIBITION MEASURE DESCRIBED IN PARTS 2 AND 4 OF SCHEDULE 14 TO THE DEVELOPMENT CONSENT ORDER, RELATE. THESE PLANS DO NOT SHOW ALL PROPOSED ACCESSES TO THE AUTHORISED DEVELOPMENT. FURTHER INFORMATION ON THE PROPOSED ACCESSES TO THE AUTHORISED DEVELOPMENT CAN BE FOUND IN THE ACCESS AND RIGHTS OF WAY PLANS AND SCHEDULE 7 TO THE DRAFT DCO.
3. THE REQUIREMENT FOR TS1 HAS BEEN REMOVED AND TRAFFIC SIGNALS START AT TS2.

KEY

- ORDER LIMITS
- ■ ■ PROPOSED TEMPORARY SPEED LIMIT (30MPH SPEED LIMIT)
- ■ ■ PROPOSED TEMPORARY SPEED LIMIT (40MPH SPEED LIMIT)
- ■ ■ PROPOSED TEMPORARY TRAFFIC SIGNAL CONTROL AREA
- ■ ■ PROPOSED TEMPORARY PROHIBITION ORDER
- ↔ INDICATIVE SITE ACCESS LOCATION

SHEET PLAN

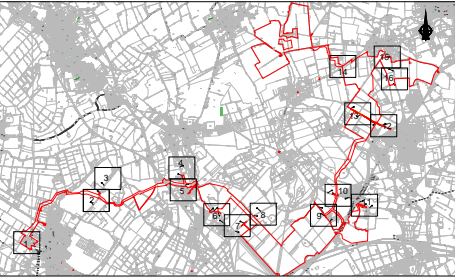

Document Reference: EN010106/APP/2.4
ISSUE/REVISION

2	11/11/2022	SUBMITTED AT DEADLINE 2
1	30/08/2022	CHANGE APPLICATION JULY 2022
0	18/11/2021	FOR DCO SUBMISSION
I/R	DATE	DESCRIPTION

SHEET TITLE

TRAFFIC REGULATION MEASURES PLANS -
TEMPORARY MEASURES
INFRASTRUCTURE PLANNING
(APPLICATIONS: PRESCRIBED FORMS AND
PROCEDURE) REGULATIONS 2009 5(2)(O)
SHEET 16 OF 16

SHEET NUMBER

60589004-TRM-TM-016

SCALE

1:2500 @ A3

This drawing has been prepared for the use of AECOM's client. It may not be used, modified, reproduced or relied upon by third parties, except as agreed by AECOM or as required by law. AECOM accepts no responsibility, and denies any liability whatsoever, to any party that uses or relies on this drawing without AECOM's express written consent. Do not scale this document.